

## deco mobil C 6000 Type Civil & Disaster

Incident scene hygiene with toilet and decontamination for people



The deco mobil C 6000 – Type Civil & Disaster- incident scene hygiene / decontamination - is designed for self-sufficient use and has two toilets and a multi-chamber system with a shower for decontamination installed. The unit ideally complements a wide range of operational concepts and provides everything needed for extensive on-site hygiene and decontamination at the incident scene.

Everything is available, from a boot washing unit to a changing room with a safekeeping outward transfer for the contaminated protective gear to a shower room and to spare outfits.



deco mobil C 6000 Type Civil & Disaster - incident scene hygiene/  
decontamination

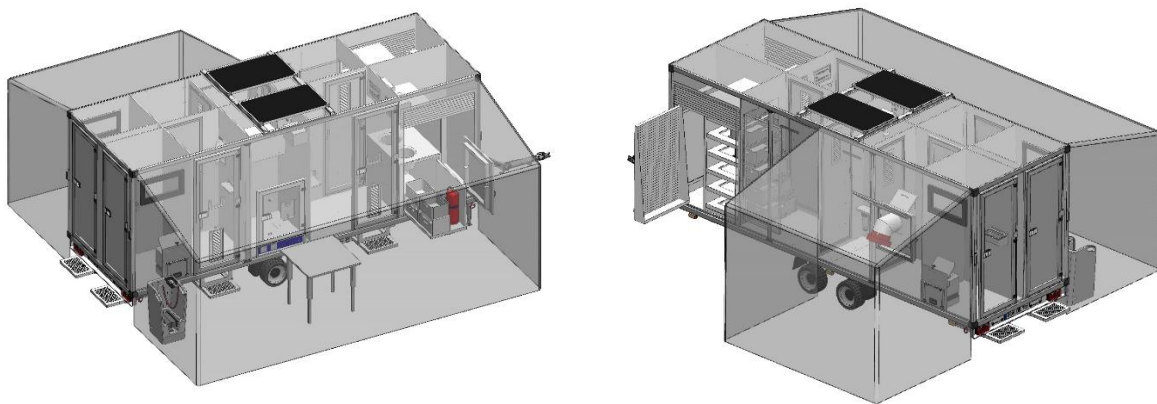

#### Technical design

Box body 5986 x 2032 x 2800 mm (L x W x H)

Tandem chassis approved for speeds up to 100 km/h

Height adjustable drawbar with exchangeable drawgear (Ball head and claw)

Gross vehicle weight 3.000 kg, bearing load max. 100 kg

Warm water production (electrical), 300 L fresh water storage and sewage filter system

Stand alone operation via batteries incl. photovoltaics or external power supply

Negative pressure system with HEPA filter, air conditioning and heating

Mobile boot washing unit with sewage filter system

Roof awning with front and side parts

Room layout:

- 2x toilets
- Containment area/ changing room with outward transfer for PPE
- Shower room with sewage filter system
- Dressing room with shelving system for towels and spare outfits
- Clean area with central smart touch system, 2x outward transfers, storage compartments and fold-up seats
- 2x equipment rooms and 1x technical room



Deco mobil C 6000 incident scene hygiene



Shower



Dressing room with wardrobe



Clean area



Toilet



Preparation room



Equipment room with pull-out



The deconta systems are manufactured entirely in-house, as well as various container variants and as vehicle bodies in Isselburg, Germany.

Hi-cube container



Roll-off container (DIN 30722)

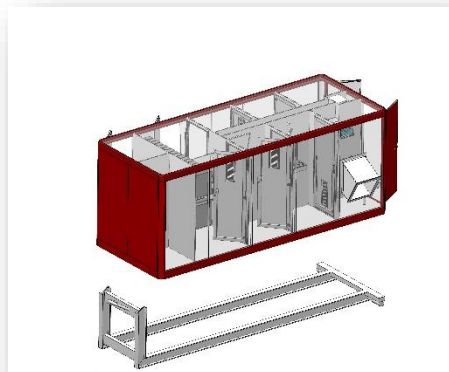

Vehicle body 7,5t



Vehicle body truck 16t

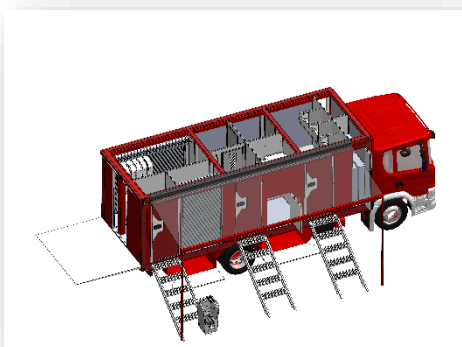

Individual solutions can also be created in addition to various basic versions.

**deconta** GmbH

Im Geer 20

46419 Isselburg - Germany

Telephone +49 (0)2874 915 632

cbrn@deconta.com

