

Instruction manual

Water Management System

C 60 L



Manufacturer: deconta GmbH
Im Geer 20, D - 46419 Isselburg

Description: Water Management **C 60 L**

Type-No.: 628

Serial-No.:

Table of contents

1.	Basic safety advice	3
2.	Transport and storage	4
2.1.	Delivery	4
2.2.	Transport	4
2.3.	Storage	4
3.	Volume of delivery	5
4.	Technical description	5
4.1.	Intended use	5
4.2.	Unit description	5
5.	Technical data	6
6.	Initial operation	7
7.	Maintenance and care	9
7.1.	Daily maintenance	9
7.2.	Filter change	9
7.3.	Reduction of legionella growth	10
8.	Circuit diagram	11
9.	Declaration of conformity	12

The copyright of this instruction manual remains with **deconta**. This manual is intended for assembly, operation and maintenance personnel. It contains instructions and drafts of technical nature which may neither be distributed or used in any unauthorised way for competitive purposes nor passed on to others.

1. Basic safety advice

The handling of the appliance technology is only allowed for instructed staff. The exact knowledge of this manual is an important condition for the staff before handling the machine.

Please keep the instruction manual close to hand and available for everybody.

As an operator, you are obliged by **deconta** to follow the instruction manual and to use this engineered technology equipment only in accordance with the regulations and its suitability! In the event of non-observance, **deconta** assumes no liability.

To ensure safety during operation of the unit, the following must be strictly observed:

- Do not use in potentially explosive areas.
- Necessary repairs and maintenance may only be performed by authorized staff.
- For all repair and maintenance work, the device is to be completely disconnected from power supply
- The safety and protective equipment is to be kept in perfect function.
- Attached safety guidelines are to be kept in a readable state and are to be followed.
- Generally applicable legal and other binding regulations for accident prevention and handling of hazardous substances must be observed.

To ensure safety, any changes on the machine are prohibited.

ATTENTION!

The Waste water filtration unit is not suitable for the use in condensed, corrosive, flammable and explosive compartment air. The ambient and medium temperature must be between +5 and +50°C.

We make explicit reference to the additional regional and national safety policies and regulations in the operation of the equipment technology.

2. Transport and storage

2.1. Delivery

If no other agreements have been made, the unit is packed safely and will be delivered ex work. Transport damages have to be immediately documented by the carrier or another supplier. Please also note the possible damages on the way bill.

2.2. Transport

The Transport is to be proceeded with care to avoid damages by improper handling or carelessness.

It is important to avoid exposure to violent shocks, otherwise the function and safety of the unit cannot be guaranteed. In winter and at risk of frost, the whole unit (Pump, filter housing and tank) needs to be emptied before transport.

Attention: Transport of unit (also relocation) only when empty.

2.3. Storage

In order to avoid damages, the installation has to be kept in a dry area with no access for unauthorized persons.

Because of risk of frost in winter it is important to observe the following:

- Empty water hoses, filter housing, tank and pumps
- Place Water Management in a frost-protected area

Advice for the draining of the tank: To drain remove cap and tilt valve.

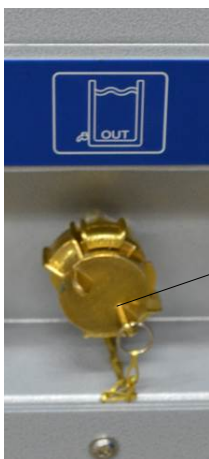

Cap

Valve



3. Volume of delivery

If no other agreements have been made, the scope of delivery of the water management unit consists of:

- Water Management System
- Filter
- Instruction manual

Return delivery after termination of rental period

We have to insist on following conditions for the return delivery in order to protect our clients and in accordance with the rules for hazardous materials transportation:

- As listed above
- Well cleaned (ready for use)
- Without binder remains
- Without damages
- Without filter

4. Technical description

4.1. Intended use

During asbestos sanitation works within closed rooms, you have to exclude that the asbestos fibres leave the sanitation area uncontrolled and endanger the human health and the environment. For this reason, personnel must leave the sanitation area through a lock system and take a shower while leaving.

The deconta water treatment system heats up the shower water and takes over the filtering of the contaminated sewage water.

4.2. Unit description

This is an electric warm water storage for the heating of shower water. Water filling can be managed manually through a filling opening (with bucket) or automatically with a permanently connected clean hose. An electrical immersion heater heats the water to shower temperature (factory-adjusted approx. 37°C). The produced shower water is pumped out by an integrated pump and filtered by a 2-stage filtration system.

5. Technical data

Volume service water:	60 Liter
Tank filling:	automatic or via filling port
Heating capacity:	2000 W
Filter stages:	2
Filter size:	10"
Power supply:	230 V
Power consumption:	11 A
Water connections:	System Geka
Dimensions (L x W x H):	510 x 520 x 1000 mm
Weight:	51,5 kg

technical changes reserved

6. Initial operation

Before the initial operation of the waste water pump or after a long period of stagnation, check that the shaft rotates freely when turned by hand. To this put a screwdriver in the notch of the shaft end on the fan side and move the shaft. The strong initial rotational resistance of the new pumps will come loose after running.

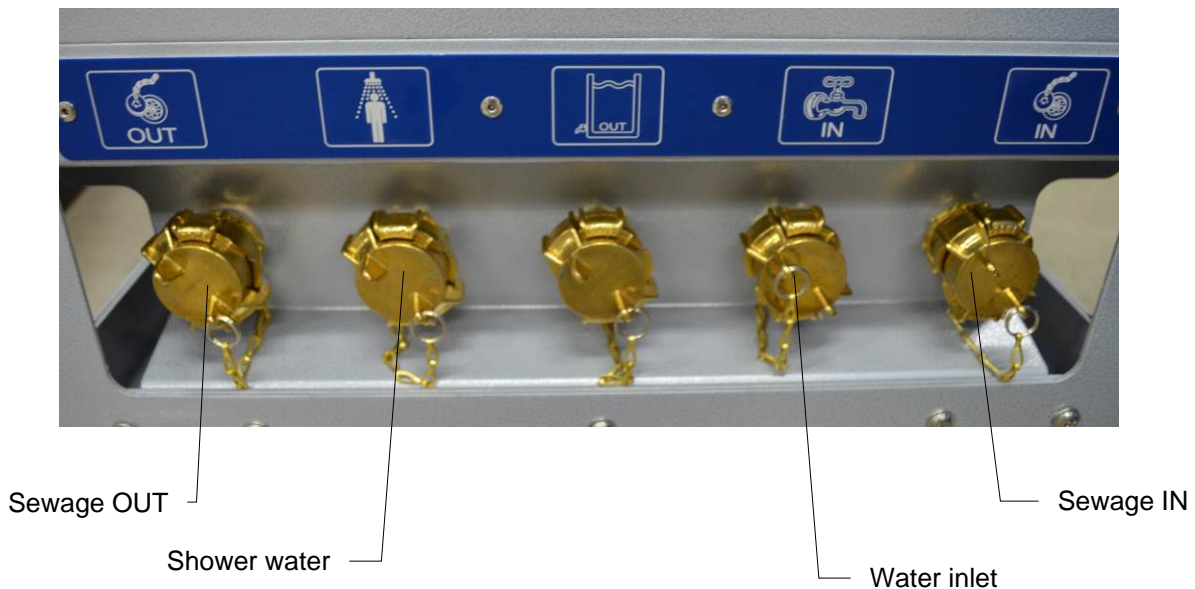

- Unplug
- Establish hose connections:
 - Optional connection „Water inlet“ with pipeline network or manually via filling opening
 - Connection „Warm water shower water“ with shower top
 - Connection „Sewage IN“ with shower tray
 - Connection „Sewage OUT“ with sewage system
- Connect to power
- when using the automatic fresh water supply the max filling level is controlled by a float switch
- the unit is now ready-to-operate

Turn switch „Warm water Start“, water now flows from shower head. The sewage pump is automatically switched on when the water starts flowing.

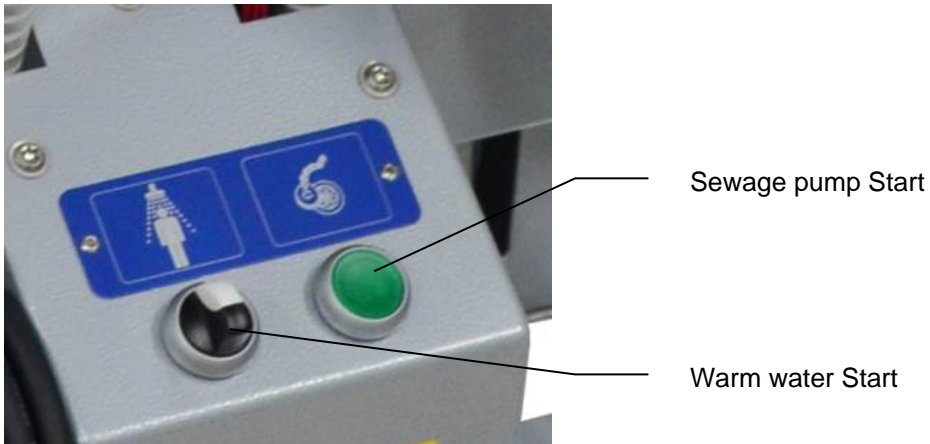

By pushing and holding of the button „Waste water pump Start“ the Waste water pump can be switched on manually.

Safety instructions:

During works on the device always disconnect the plug!
Operate the device only with mains which are secured with fault current protection switch!
Never operate the device without water! In case of frost risk, empty the device by opening the stopcock!
Check outlet temperature before every shower!
CAUTION! Danger of scalding

7. Maintenance and care

7.1. Daily maintenance

- Check hoses for free flow
- Visual check of 220 μ -Pre filter for dirt
- Control of fine filter via manometer

7.2. Filter change

The Manometer controls the fine filter. We recommend a filter change at approx. 3bar.

Attention:

- Change Filter only when device is switched off
- Demount dirty filters only in wet shape to avoid contamination
- Use approved filters only
- Do not use damaged filter candles



Filter change:

- Loosen cap nut with help of filter head screw
- Remove filter and dispose of it
- Insert new filter candles
- Pay attention to correct fit and cleanliness of the seal ring
- **Tighten** the nut

The suction hoses, pumps, filter housings and filter are contaminated after the first use. Repairs and maintenance have to be executed only under the observance of all relevant safety measures. All the filters mentioned have to be disposed of according to the legal terms.

7.3. Reduction of legionella growth

To avoid excessive legionella growth, we recommend to heat the water in the tank to a temperature around $>60^{\circ}\text{C}$ once or twice a week.

To clean the hoses and the shower, the heated water should also be removed from the shower for about 3 minutes.

Caution risk of scalding!

Alternatively, an approved disinfectants can also be used.

8. Circuit diagram

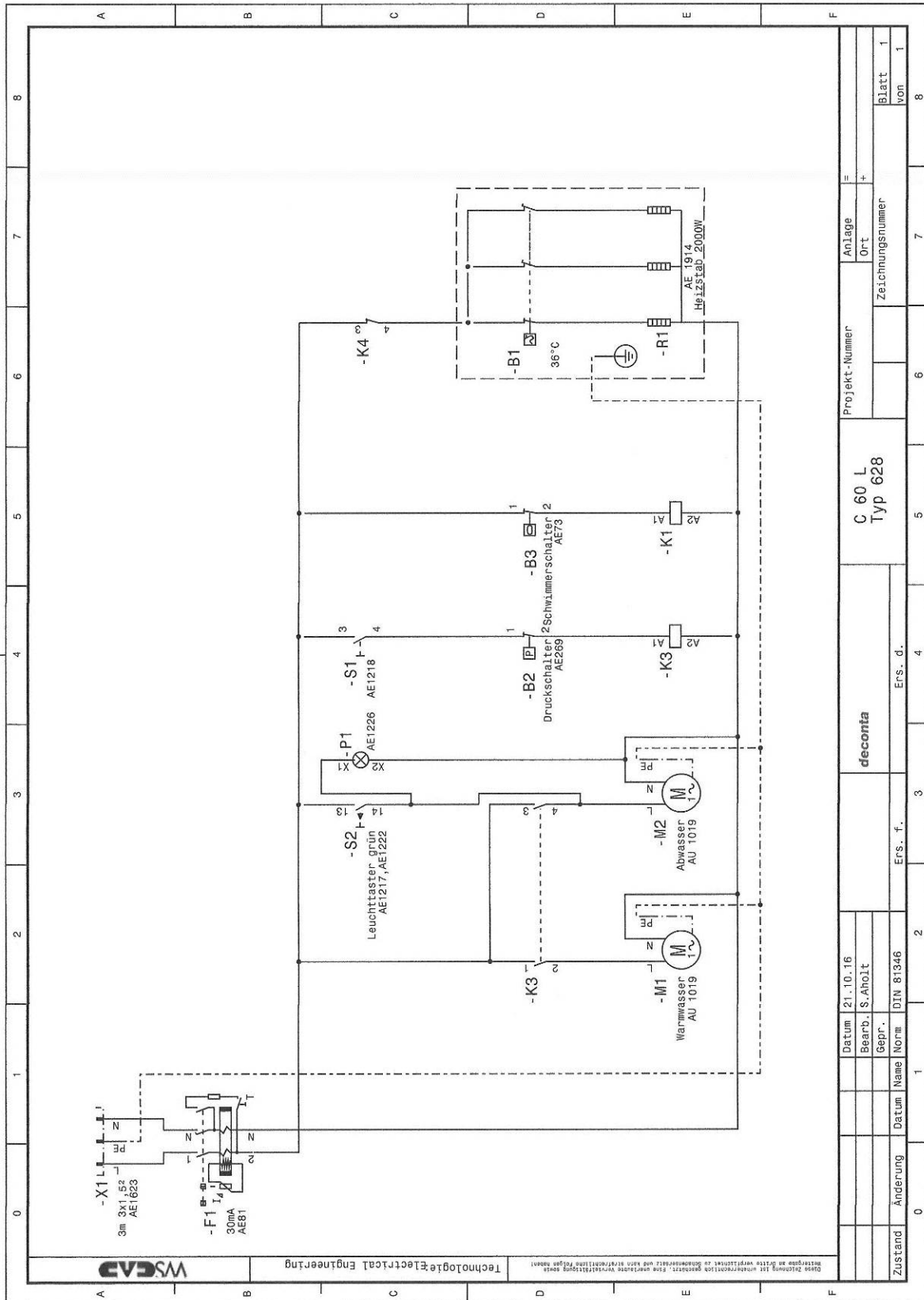

WSPCAD

TechnologieElectrical Engineering

Diese Zeichnung ist urheberrechtlich geschützt. Eine unautorierte Vervielfältigung dieser Zeichnung ist strafbar.

Zustand	Anderung	Datum	Name	Norm	Ers. f.	Ers. d.
				DIN 81346		
Datum			21.10.16			
Bearb.			S.Ahoit			
Gepr.						
Anlage			C 60 L			
Ort			Typ 628			
Projekt-Nummer			deconta			
Zeichnungsnummer						
Blatt			1			
von			1			

9. Declaration of conformity

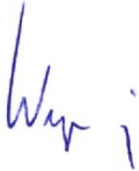
EC-Declaration of conformity	
deconta GmbH Im Geer 20 D-46419 Isselburg	
Product: Water Management C 60 L	Type: 628
The design of the unit complies with the following directives:	EC-Machine directive 2006/42/EG EC-Low voltage directive 2006/95/EG
Applied harmonised standards:	EN 292, EN 60335-1
Applied national standards:	DIN VDE 0701, DIN VDE 0702
 W. Weißling	Isselburg, 23.11.2016